

Mounting Instructions
LANCOM
DPSU-480/55

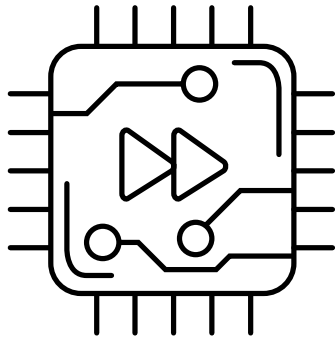

Front view of the power supply unit

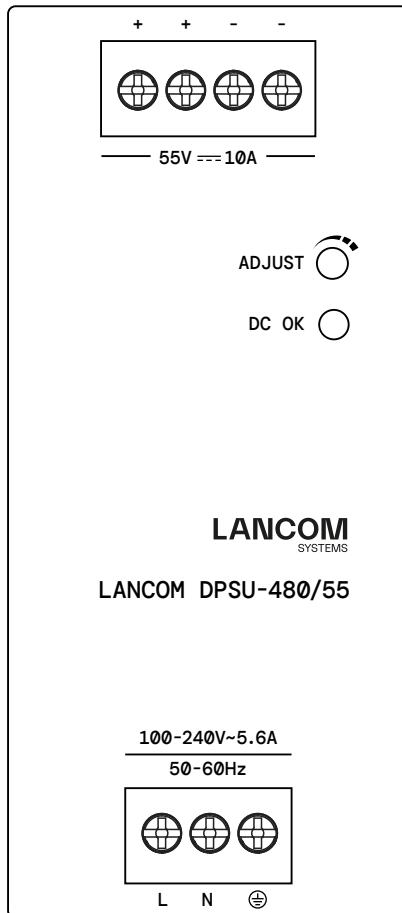

- A** Terminal block for output voltage
-
- B** Potentiometer for adjusting the output voltage between 48 V and 55 V.
For PoE operation of a switch, the potentiometer must be set to maximum.
-
- C** DC OK LED (Green)
-
- D** Terminal block for input voltage

Mounting the power supply unit

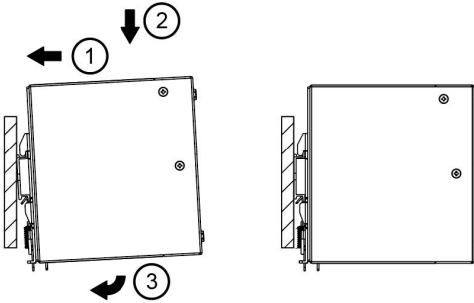

Snap the power supply unit onto the DIN rail as shown:

- Tilt the front of the power supply unit upwards and place it on the DIN rail.
- Press the power supply unit down as far as it will go.
- To lock, press against the front of the power supply unit in the lower area.
- Check that the power supply unit is firmly seated on the DIN rail.

Disassembling the power supply unit

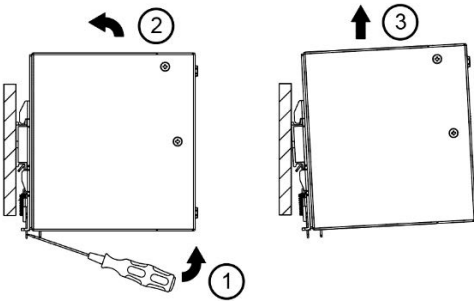

- To remove the power supply unit from the DIN rail, pull the latch on the back of the power supply unit downwards from the front using a screwdriver, as shown in the illustration.
- Then tilt the front of the power supply unit upwards with the lock pulled.
- Remove the power supply unit upwards from the DIN rail.

Safety instructions

- **Always** switch off the power supply **before** connecting or disconnecting the input voltage to the device. If the power supply is not switched off, there is a risk of explosion or serious damage.
- To ensure adequate ventilation, maintain a distance of 40 mm (1.57 inches) above and 20 mm (0.79 inches) below the appliance and a lateral distance of 5 mm (0.2 inches) from other appliances; if the load is less than 50%, the lateral distance can be 0 mm. If the neighboring appliance is a heat source, the minimum side clearance is 15 mm (0.6 inch).
- Please note that the housing of the device can become very hot depending on the temperature of the ambient air and the load on the power supply unit. There is a risk of burns!
- The power supply must be disconnected before connecting or disconnecting wires to the terminals.
- Do not insert any objects into the appliance.
- Dangerous voltages may still be present up to 5 minutes after the input voltage has been switched off. Do not touch the device during this time.
- The power supply unit is a built-in device and must be installed in a cabinet or room that is relatively free of conductive impurities (condensation-free environment and interior).

Device name

LANCOM DPSU-480/55

Terminal block for input voltage

Input voltage 100 to 240 VAC / 50 to 60 Hz
(L, N, grounding)

Terminal block for output voltage

Output voltage (2x + -) Typ. 55 VDC; max. 57.5 VDC @10 A
 Max. Output power 480 W
 Control range (ADJUST) 48 to 55 VDC
 For PoE++ operation (IEEE 802.3bt), the output voltage must be at least 55 VDC.

Mechanical data

Dimensions (mm) 123.6 × 56 × 116.8 (H x W x D)
 Operating temperature (°C) -30 to +50

De-rating curve
Output Load vs. surrounding air temperature

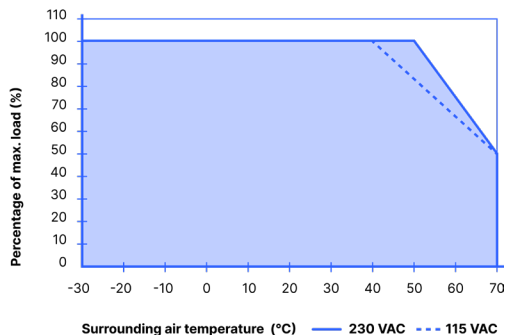

Humidity in operation (%) 20 to 90 (relative humidity, non-condensing)

Housing material Aluminium

Mounting options Standard TS35 DIN rail according to EN 60715

Item

Warranty 2 years

Item number 61435